

C Series Capstans

Lewmar's C Series Capstans provide almost effortless rope control at the press of a footswitch. The WARP™ (Wear and Abrasion Resistant Pattern) finished drum optimizes performance and reduces rope wear by up to 30%. Stainless steel components combine strength, anti-corrosion and durability with a beautiful, polished finish. Installation of the C3 is quick and simple, as it is fastened entirely from above deck.



- Beautifully crafted stainless steel components ensure enduring strength and performance
- WARP™ finish drum - unique Wear and Abrasion Resistant Pattern reduces rope wear by 30%
- C3 offers quick, easy on-deck installation requiring only one person
- C4–C10s have worm gearbox-inherent anti-runback characteristics acting as a mechanical brake

Capstan selection guide

Model	BOAT LENGTH OVERALL									
	6 m 20 ft	12.2 m 40 ft	18.3 m 60 ft	24.4 m 80 ft	30.5 m 100 ft	36.6 m 120 ft	42.7 m 140 ft	48.8 m 160 ft	55 m 180 ft	
C3										
C4										
C5										
C6										
C10										
C12										

Lighter shading represents the upper limit of model. If in doubt, move up a model.



C-Series Capstans

Refer to page 34 for switch kit and accessories

C Series Capstan Electric Specifications

DESCRIPTION	MOTOR POWER Watt	MAXIMUM PULL		WORKING LOAD LIMIT		MAXIMUM LINE SPEED		NORMAL CURRENT DRAW Amp	CIRCUIT BREAKER Amp	WEIGHT	
		kg	lb	kg	lb	m/min	ft/min			kg	lb
C3 - 12V	1000	750	1650	188	414	12	39	65	70	12	26
C3 - 24V	1000	850	1870	213	470	12	39	40	50	12	26
C4 - 12V	1600	1250	2750	313	690	25	82	125	150	25	55
C4 - 24V	2000	1500	3300	375	827	27	89	70	110	25	55
C5 - 12V	2000	1450	3190	363	800	27	89	120	150	27.5	60
C5 - 24V	2000	1600	3520	400	882	29	97	60	110	27.5	60
C6 - 24V	2000	1540	3388	770	1698	40	131	90	-	30	66
C4 - 400V AC											
C10 - 400V AC	4000	2400	5280	1200	2640	20	66	9	10		

C Series Capstan Hydraulic Specifications

MODEL	NORMAL PRESSURE		FLOW RATE		MAX. PULL		MAX. LINE SPEED	
	bar	psi	l/min	US gal/min	kg	lb	m/min	ft/min
C4/5 Hydraulic	175	2537	10-40	2.6-10.6	1100 at 14 bar	2400 at 203 psi	21 at 40/min	69 at 10.6 US gal/min
C10 (200 cc/rev)	175	2573	20-55	5.2-14.3	2420	5324	8-23	26-75
C12 (250 cc/rev) 13.5:1 G/Box	155	2279	30-80	7.8-20.8	5000	11000	6-17	20-56

C Series Capstan

Dimensions Diagram

C3 Capstan Kits

PART NO.	DESCRIPTION
6630331312	C3 - 12V integrated deck unit & motor gearbox
6630332312	C3 - 24V integrated deck unit & motor gearbox

1 Deck Unit

PART NO.	DESCRIPTION
66810032	C4/5 Deck Unit
69000411	C6 Deck Unit
69000453	C10/12 Deck unit

2 Motor/Gearbox

PART NO.	DESCRIPTION
68000534	C4 - 12V Motor Gearbox
68000535	C4 - 24V Motor Gearbox
68000901	C4 - 400V AC
66810011	C5 - 12V Motor Gearbox
66810012	C5 - 24V Motor Gearbox
68000294	C4/5 Hydraulics
69000414	C6 - 24V Motor Gearbox
69000491	C10 4kW, 400V AC
69000456	C10 Hydraulics
69000458	C12 Hydraulics

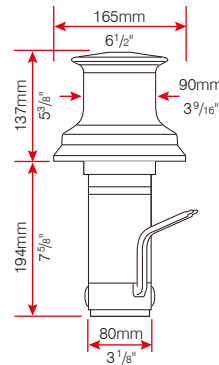

C3 Integrated Deck Unit and Motor Gearbox

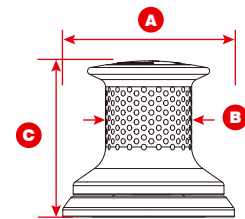

C4/5 & 6 Deck Unit

Dimensions

	A		B		C	
	mm	in	mm	in	mm	in
C4/5	215	8 1/2	108	4 1/4	196	7 3/4
C6	230	9 1/16	130	5 1/16	219	8 5/8

Cable Sizes

PRODUCT	VOLTAGE	LENGTH OF CABLE RUN			SWITCH WIRING	CURRENT RATING FOR SWITCH WIRE Amps
		0-7m / 0'-23'	7-15m / 23'-50'	15-22m / 50'-73'		
C3	12	10mm ² / 8 AWG	16mm ² / 4 AWG		1.5mm ² / 16 AWG	5
C3	24	6mm ² / 10 AWG	6mm ² / 8 AWG		1.5mm ² / 16 AWG	5
C4	12	25mm ² / 3 AWG	35mm ² / 0 AWG	50mm ² / 0 AWG	1.5mm ² / 16 AWG	5
C4	24	10mm ² / 8 AWG	16mm ² / 4 AWG	25mm ² / 2 AWG	1.5mm ² / 16 AWG	5
C5	12	25mm ² / 3 AWG	35mm ² / 0 AWG	50mm ² / 0 AWG	1.5mm ² / 16 AWG	5
C5	24	10mm ² / 8 AWG	16mm ² / 4 AWG	25mm ² / 2 AWG	1.5mm ² / 16 AWG	5
C6	24	10mm ² / 8 AWG	16mm ² / 4 AWG	25mm ² / 2 AWG	1.5mm ² / 16 AWG	5

The above cable sizes are recommendations only.